



Bulk Pro™ Low-Profile Tailgate Spreaders

Spreaders for Snow & Ice Control

FOR MODEL

PRO -1575

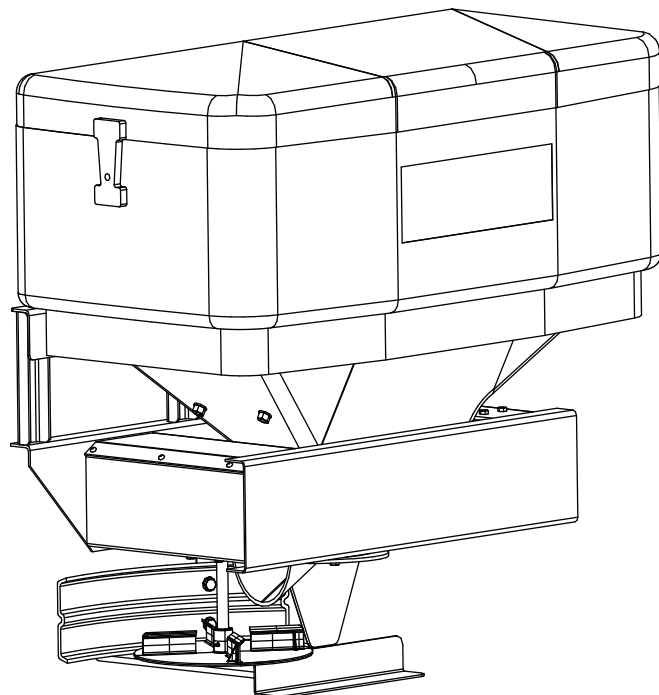

PRO 1575
Exploded Assembly

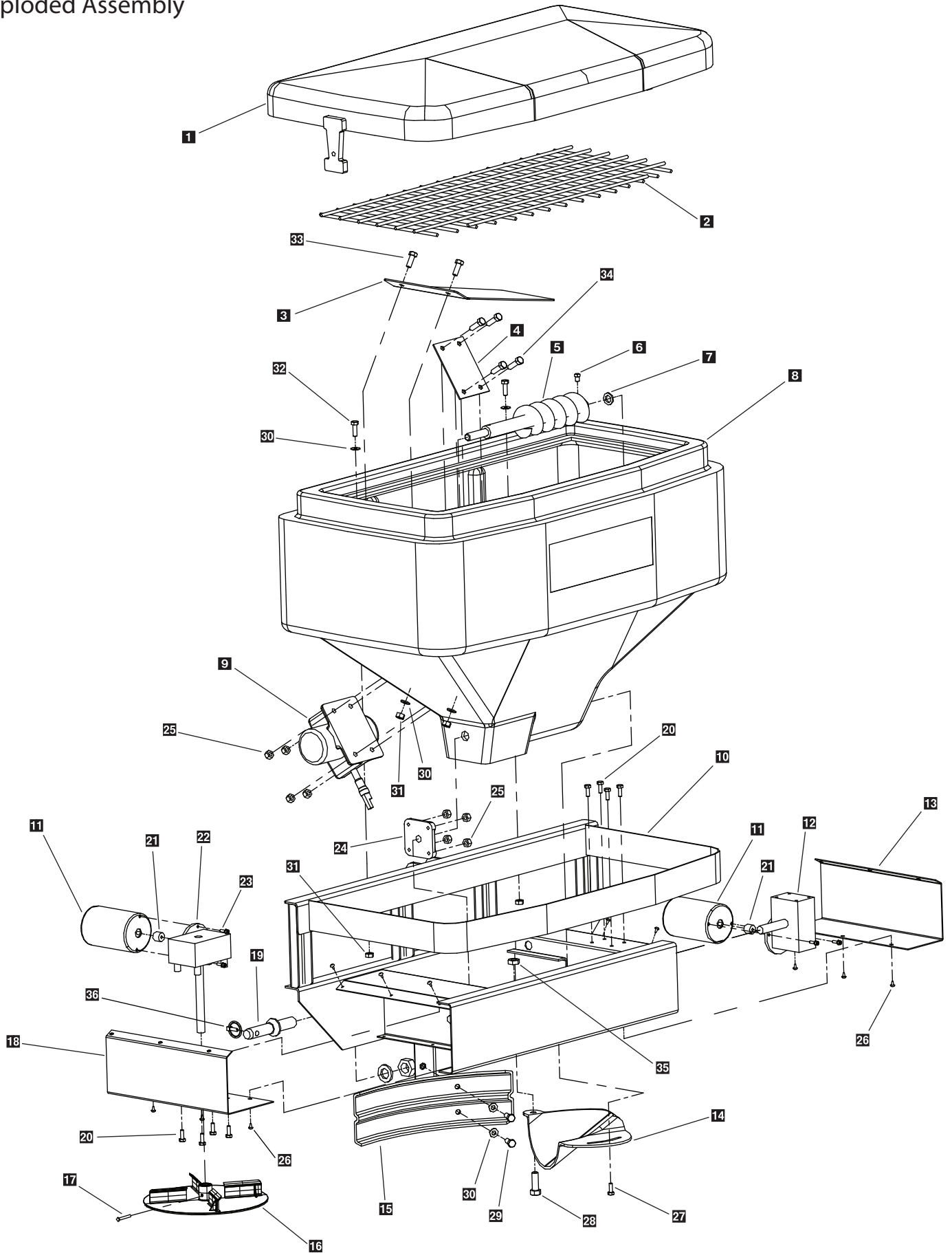

PRO 1575

MAIN ASSEMBLY PARTS BREAKDOWN

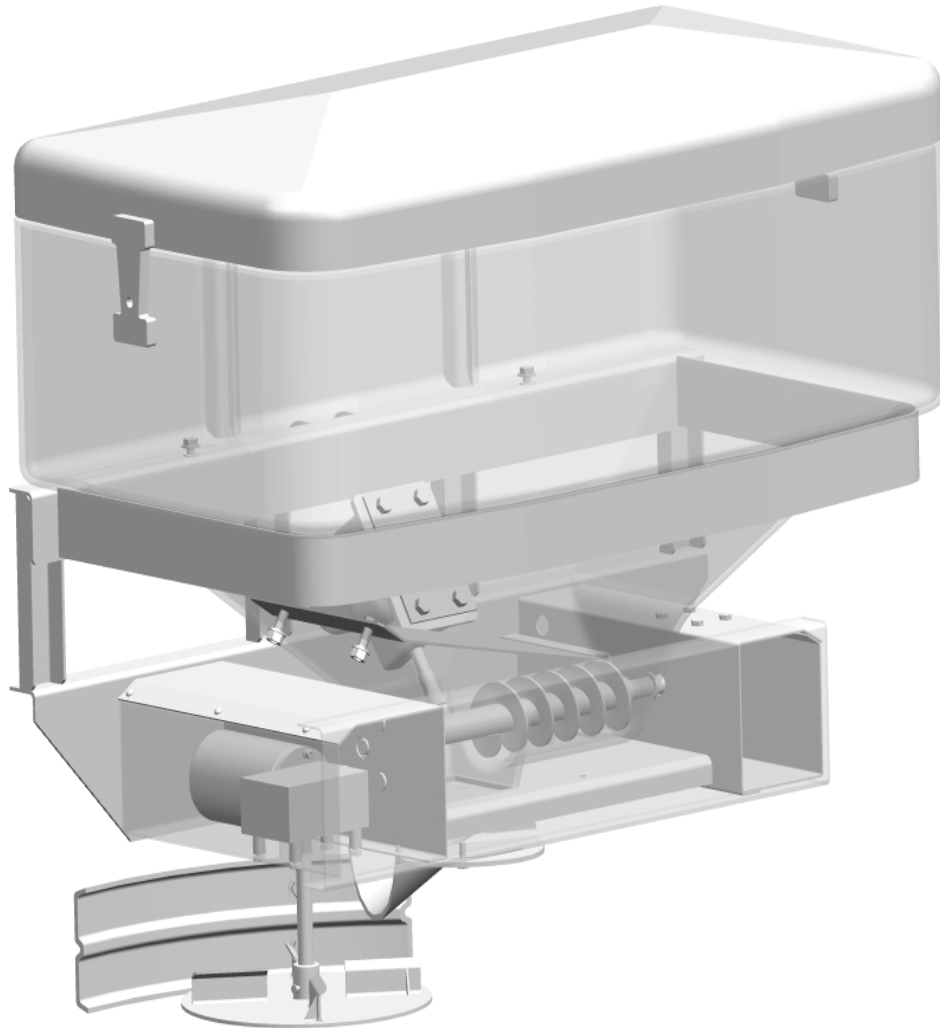

Key	Part No.	Description	Qty.	Key	Part No.	Description	Qty.	Key	Part No.	Description	Qty.
1	D6240	1575 Lid Assembly	1	16	D6750	4 Flite Plastic Spinner	1	31	D5706	5/16-18 Serr. Hex Nut	4
2	D6257	1575 Top Screen	1	17	D6746	Ball Detent Pin	1	32	D6166	5/16-18 x 1 Hex Bolt	2
3	D5114	1 Pc. Material Baffle	1	18	D5106	Spinner Motor Cover	1	33	D6137	5/16-18 x 1-1/4 PH Screw	2
4	D5119	Vibrator Backing Plate	1	19	D5121	7/8 x 5/8 Clevis Pin	2	34	D4122	3/8-16 x 1-1/2 HH	4
5	D5105	10" Auger Assembly	1	20	D6131	1/4-20 Serr. Hex Bolt	8	35	D4120	1/2-13 Lock Nut (see pg 9)	
6	D6140	5/16-18 x 1/2 Set Screw	1	21	D6232	Motor Trans Coupler	2	36	D4133	5/16 Lynch Pin	1
7	D5115	5/8 USS Nylon Washer	1	22	D6107	Spinner Transmission	1				
8	D5100	1575 Yellow Hopper	1	23	D6172	10/32 x 5/8 Serr Flg Bolt	4				
9	D6174	12 Vdc Vibrator	1	24	D6512	Auger Bearing W/Cap	1				
10	D5102	1575 Main Frame	1	25	D6584	3/8 Serrated Flg Nut	8				
11	D6320	Auger & Spinner Motor	2	26	D6130	3/16 Blk Alum Rivet	12				
12	D6566	Auger Transmission	1	27	D6874	1/4 x 1-1/2 Self Driller	1				
13	D5107	Auger Motor Cover	1	28	D4123	1/2-13 x 1-1/2 HH	1				
14	D5118	Plastic Material Chute	1	29	D4121	3/8-16 x 1 Hex Head	2				
15	D6327	Plastic Deflector	1	30	D4125	3/8 Flat Washer	6				

PRO 1575 Mount Assembly

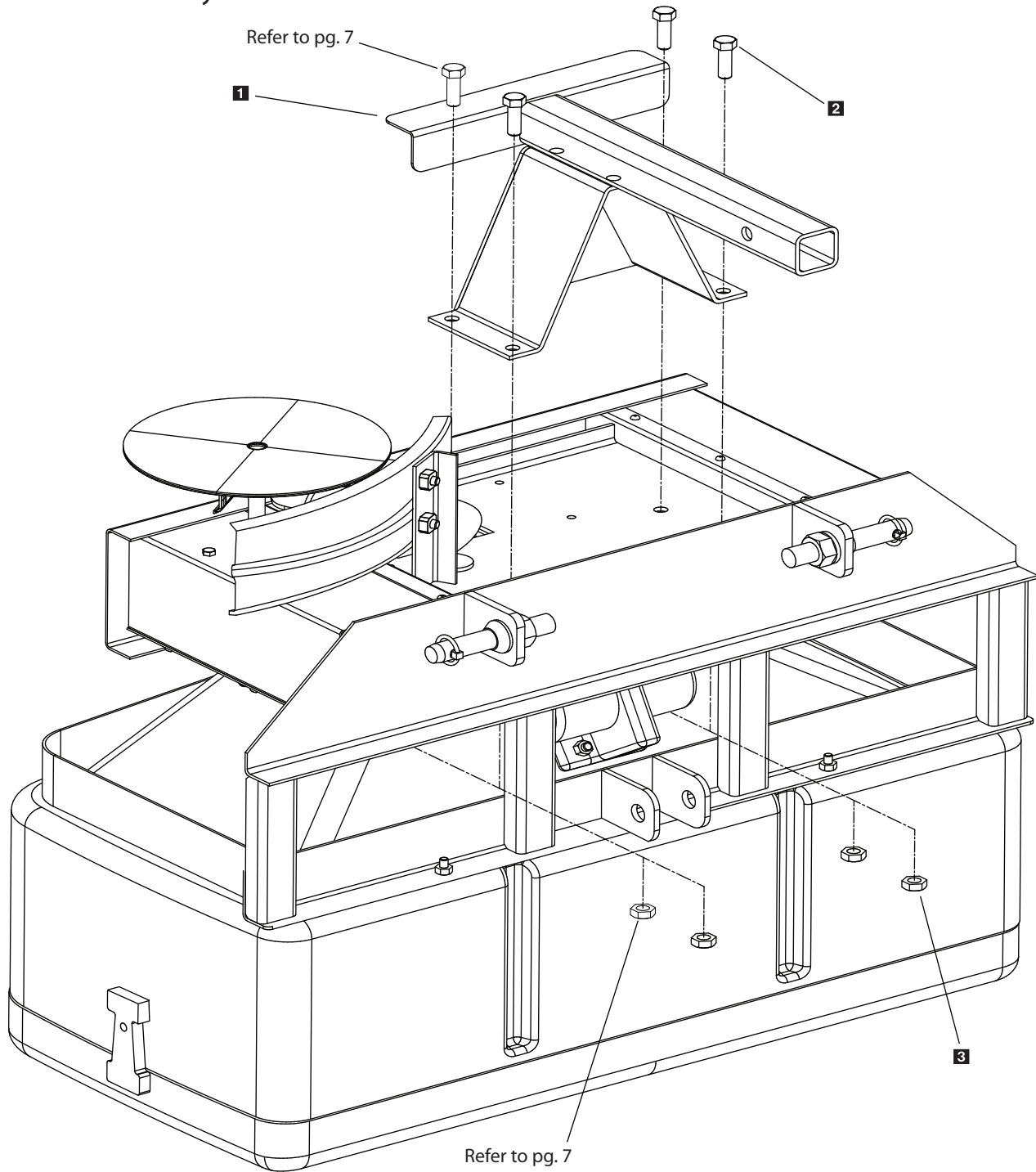

Key	Part No.	Description	Qty.
1	D5104	2" Receiver Mount	1
2	D4116	1/2-13 x 1 Hex Head Bolt	3
3	D4120	1/2-13 Lock Nut	3

PRO 1575
Assembly Views

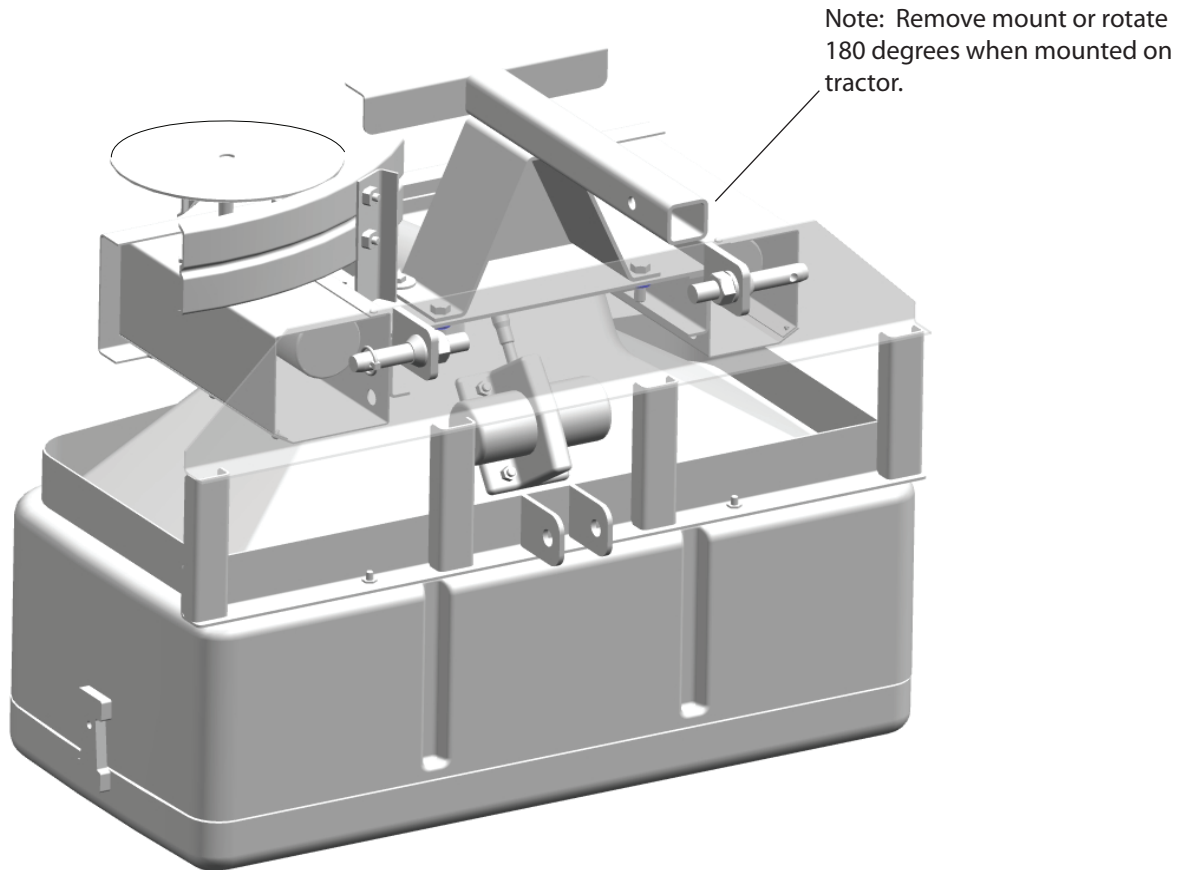
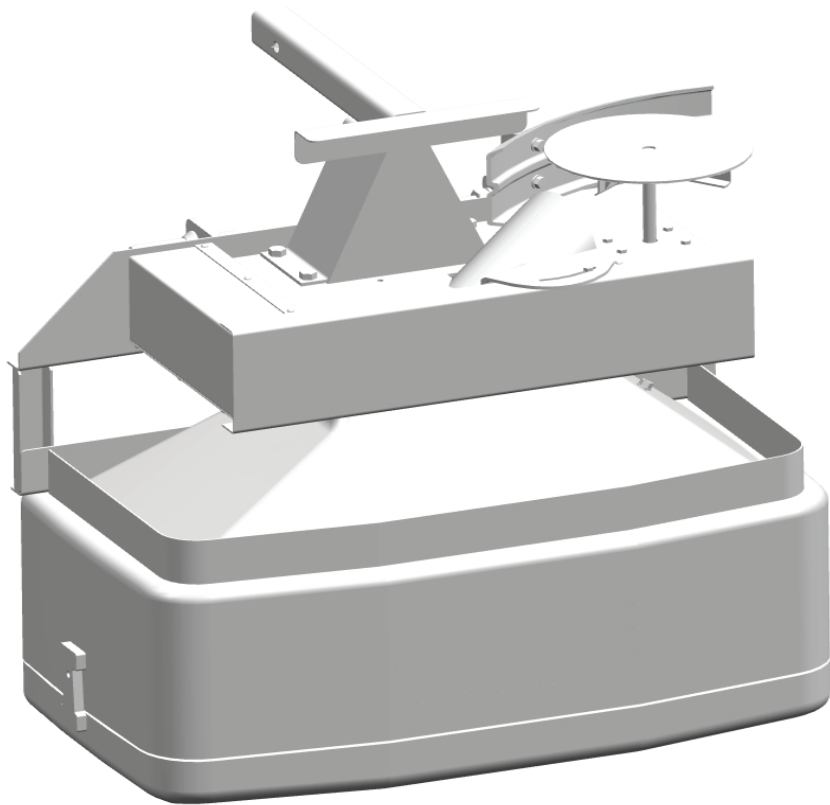

PRO 1575

Electrical System

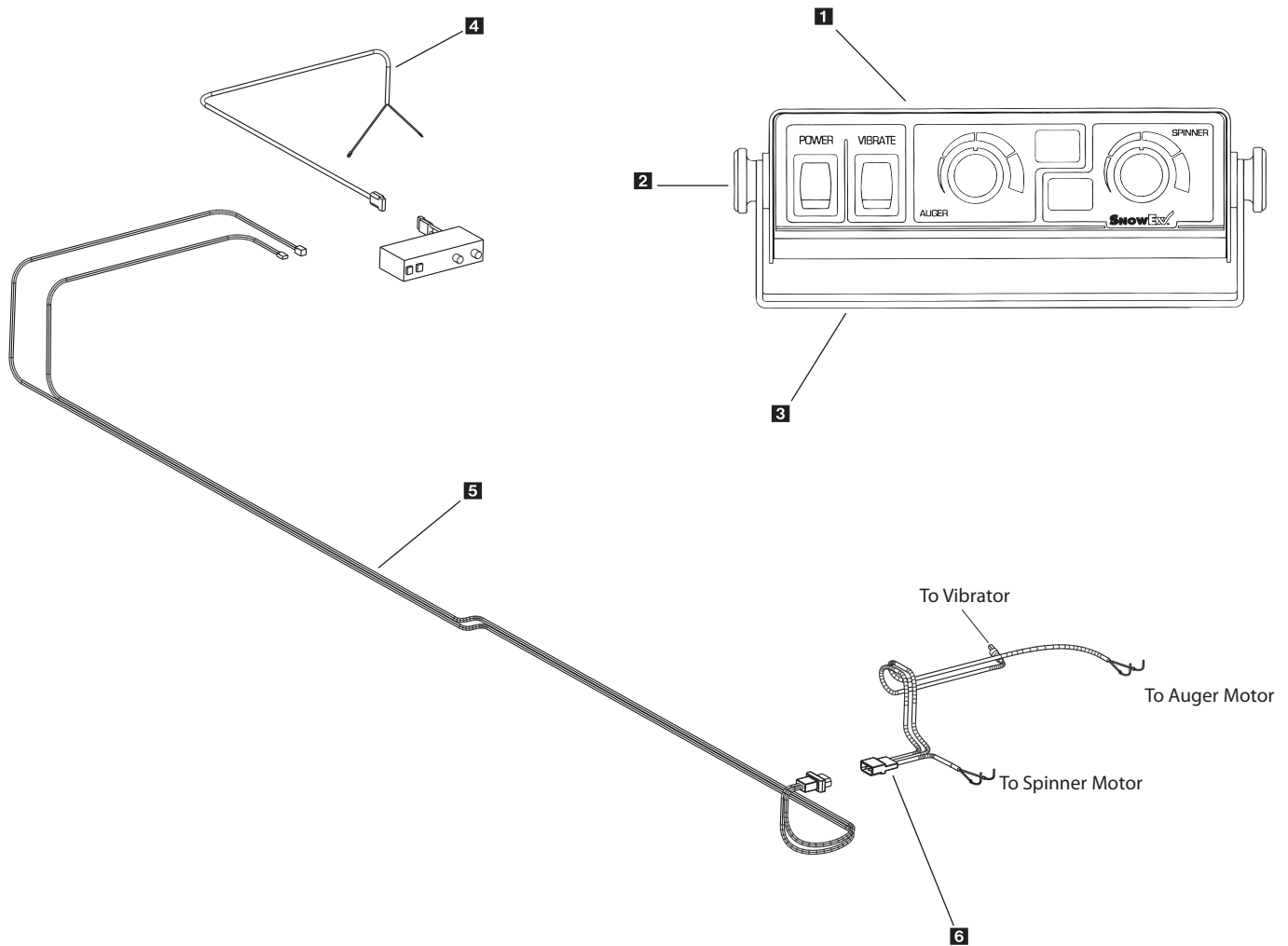

Special Notes:

1. All external connections must have dielectric grease.
2. Read lead labels before attaching to power source or ground.
3. No other devices may be spliced into wiring harness.
4. Any repairs to wiring harness must be done with heat shrink butt connectors.
5. If inline fuse is installed, use a 60 amp maxi fuse or circuit breaker.

Key	Part No.	Description	Qty.
1	D 6527	1575 Controller	1
2	D 6124	Bracket Knob	2
3	D 6329	1575 Controller Bracket	1
4	D 6341	Control Power Cable	1
5	D 5109	1575 Wiring Harness - 25'	1
6	D 6321	Power Cord - 48"	1
	D 6118	Dust Cover (not shown)	1
	D 6344	Dielectric Grease - 1 1/2 oz. (not shown)	1

D6322 Vehicle Harness Circuit Diagram

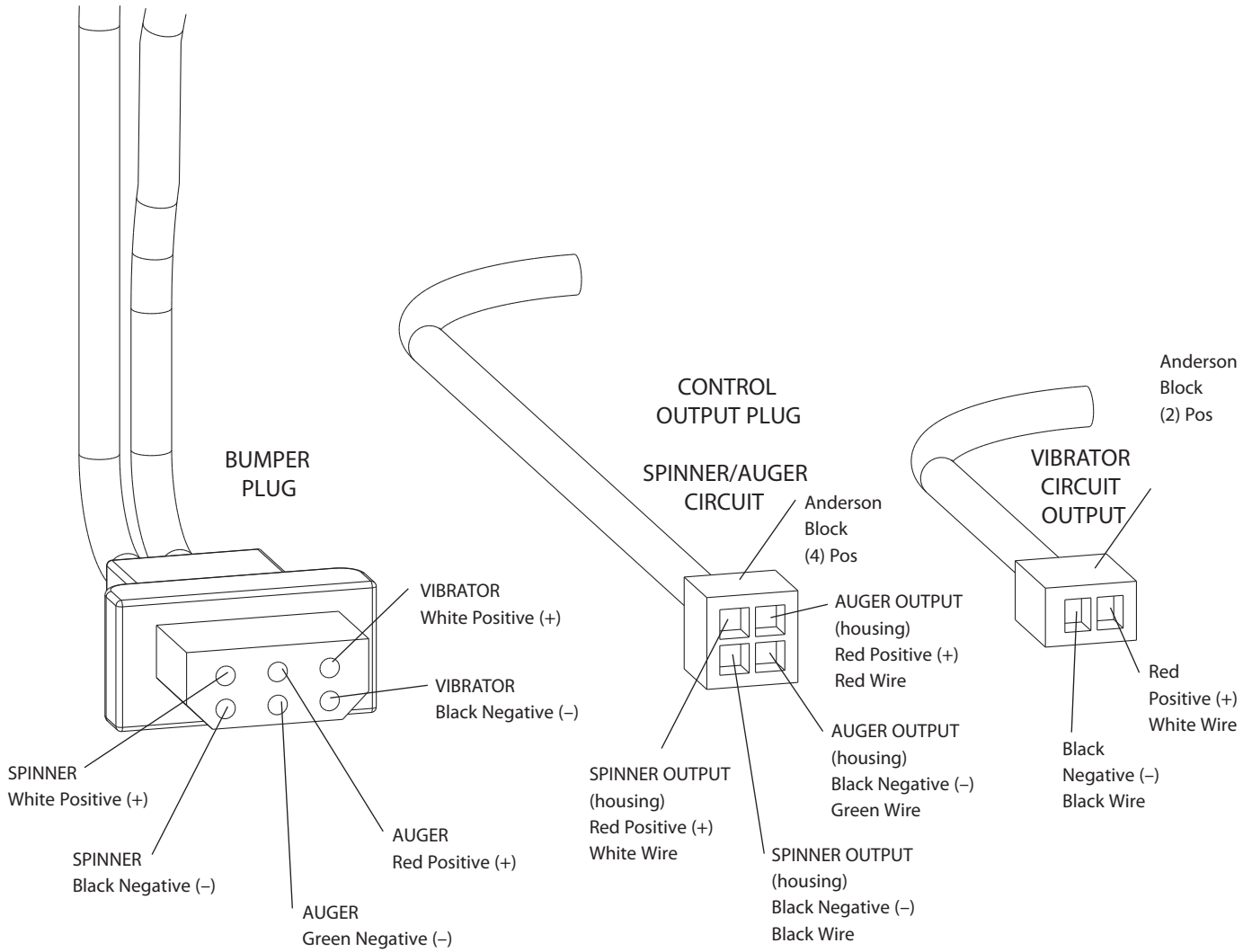

* NOTE: Reference Bumper Plug for Color Code

PRO 1575

D6321 Spreader Power Harness Circuit Diagram

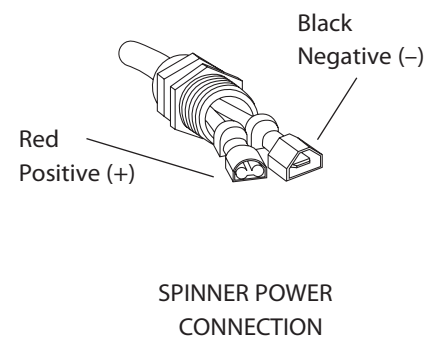
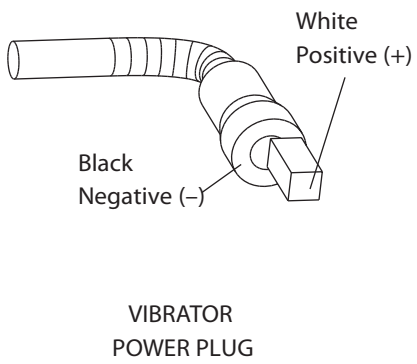
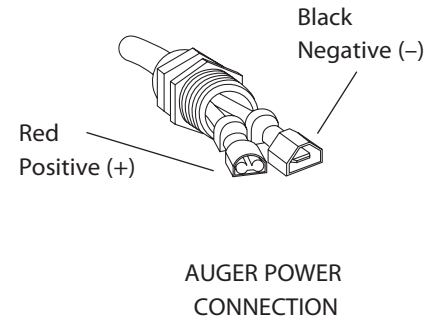
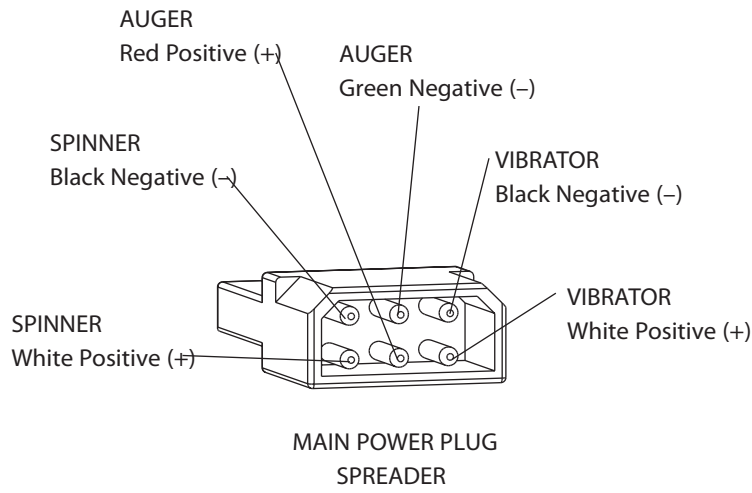

PRO 1575
D6527 Control

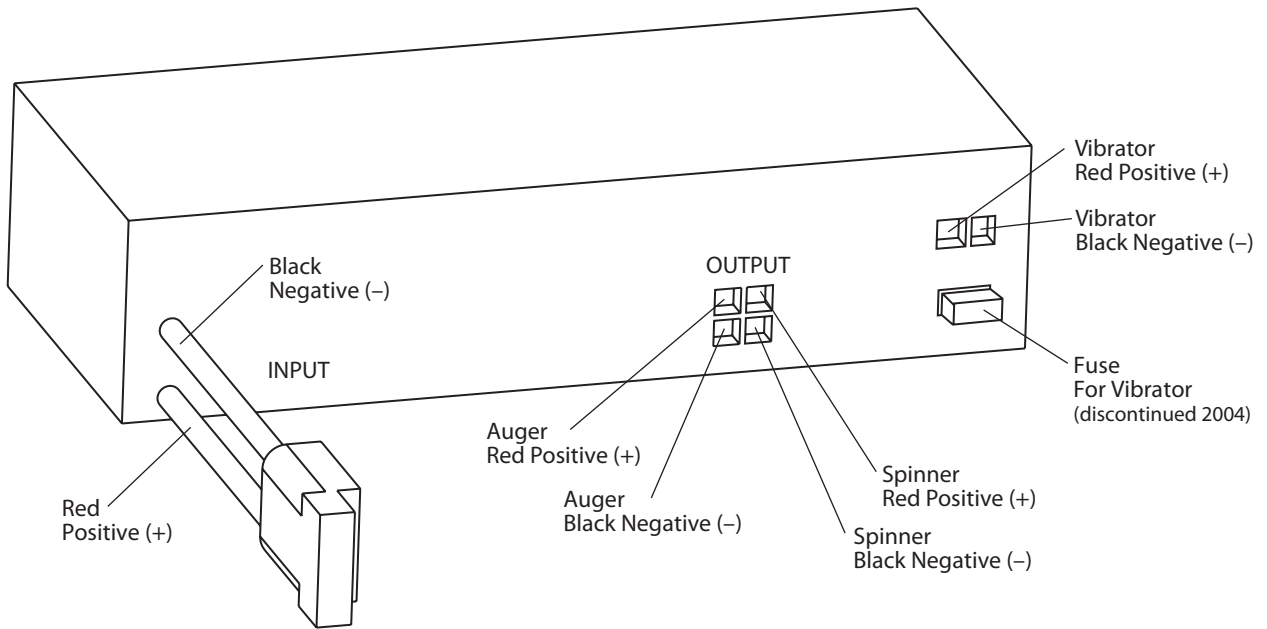

D6341 Control Power Cable

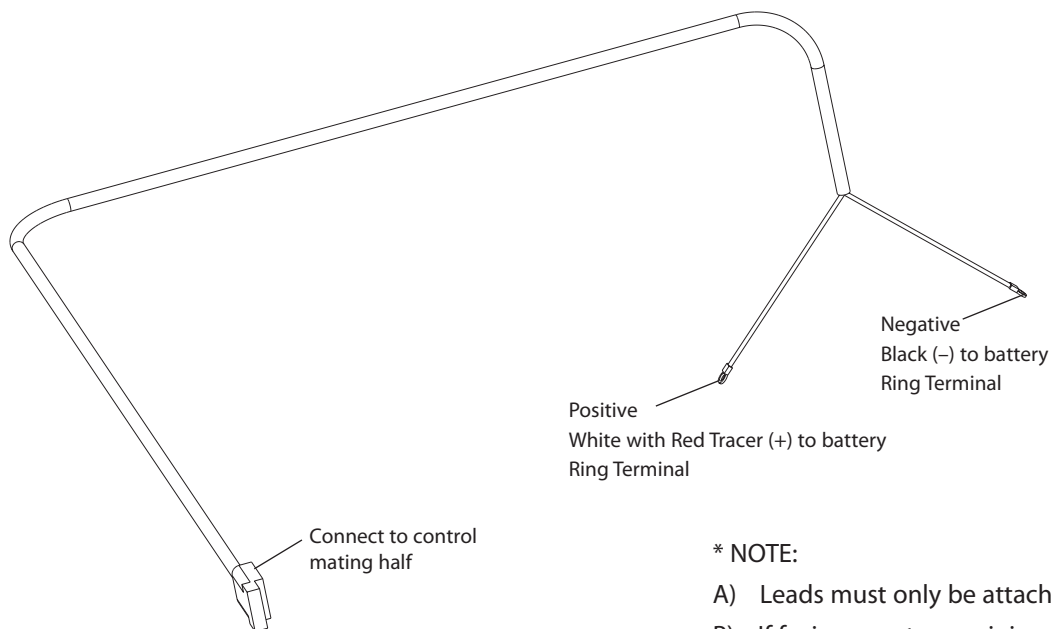

* NOTE:

- A) Leads must only be attached to battery.
- B) If fusing, must use minimum 60 Amp Maxi type fuse.